

Instruction Manual

SAFEDI is designed for use in companies, shops, enclosed spaces, as well as outdoors. If possible, every person within the respective community should wear SAFEDI, in order to maintain a comprehensive and effective system.

Important: Each SAFEDI, together with the SAFEDI identification number (ID) and the QR-Code included in the packaging, forms an inseparable unit. Every SAFEDI-User should keep their SAFEDI-ID and QR-Code permanently and securely! The activation of the anonymous close contact diary is only possible with the original QR-Code!

- CAUTION: Environmental influences and various postures of the SAFEDI user can affect the warning area.
- CAUTION: SAFEDI does not protect against infection!

Aufbau:

- 1 -LED status display
- 2 -Attachment clip, rotatable
- 3 -Charging port

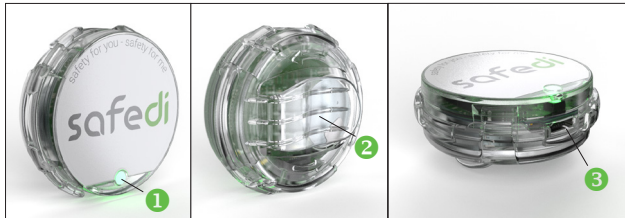

LED status display – optical and acoustic distance warning signals:

Flashing Green: SAFEDI in operation, battery status OK, close contacts have already been recorded.

Constant Green: Battery is fully charged (only visible when connected to the charging cable).

Flashing Red: Close contact – increase distance immediately! After a close contact of 3 seconds, this is recorded in the anonymous close contact diary.

Single flash Magenta: As soon as an entry has been recorded in the anonymous close contact diary, the LED briefly lights up Magenta. With the first close contact between two SAFEDIs, an acoustic signal sounds.

Flashing White: Replaces the flashing green light, as soon as SAFEDI has synchronized and no close contact has been recorded yet.

Flashing Orange: Battery almost empty: Charge the battery now.

Flashing Blue (exclusively for the SAFEDI Synchro Hub Station): SAFEDI has been synchronized and is now in charging mode.

Constant Blue (exclusively for the SAFEDI Synchro Hub Station): SAFEDI has been synchronized and is fully charged.

Operation

Charging the battery:

1. Connect a Micro-USB charging cable to the charging device and the SAFEDI charging port (5 V DC, min. 0,1 A). Charger and cable are not included in the delivery. The cable is optionally available online (www.safedi.com). If a SAFEDI Synchro Hub is used, plug the SAFEDI into the charging station.
2. The battery will be charged. The status display flashes orange when the battery is low and green at a medium level. When using a SAFEDI Synchro Hub, the status display firstly flashes green, then blue once the SAFEDI has been synchronized.
3. As soon as the battery is fully charged, the status display will light up green continuously. Exception: When using a SAFEDI Synchro Hub, the status display lights up blue continuously as soon as the SAFEDI has been synchronized. An empty battery takes approximately 2 hours until it is fully recharged.

Turning on SAFEDI:

1. Charge fully before using SAFEDI for the first time (see "Charging the battery"). This ends the transportation mode and SAFEDI is ready to be used.
2. Attach SAFEDI using the attachment clip to the front upper area of the body. The device must be attached to the top layer of clothing and must be visible.
3. Rotate the attachment clip until the logo on the device can be read horizontally or the LED status display is at the bottom ("6 o'clock").
4. SAFEDI turns on as soon as it is moved.



Standby mode:

The Standby mode is initiated when SAFEDI is placed with the label side down for approximately 3 seconds. In Standby mode SAFEDI flashes blue, it does not react to other SAFEDIs and is "invisible" to other devices. Simply move again to activate.

Find SAFEDI:

In the SAFEDI App press the button "Find SAFEDI", then the SAFEDI searched for will beep for 10 seconds and will flash alternately magenta and turquoise.

Function 1 – "Contact tracing with the anonymous close contact diary"

Each SAFEDI has an assigned anonymous close contact diary, which records which SAFEDIs have come into close contact with each other. When registering the anonymous close contact diary, the device can optionally be activated using the SAFEDI app and the QR-Code via smartphone or via the SAFEDI Synchro Hub. In both cases the QR-Code in the original packaging is essential for this!

Activate close contact diary:

Activation via a smartphone:

To activate the close contact diary, first install the SAFEDI app on a smartphone. Simply visit the SAFEDI website: <https://www.safedi.com/app> and follow the instructions. The app is available for Android and iOS.

Activation via the SAFEDI Synchro Hub:

In the SAFEDI Synchro Hub app select the menu item "Activate SAFEDI". A window will immediately appear, in which the SAFEDI-ID can be scanned. The scanning can be achieved via the camera in the tablet. Hold the SAFEDI-ID in front of the camera. The process takes a few seconds. As soon as the SAFEDI has been activated, a corresponding notification window appears. Repeat the process until all SAFEDIs have been activated.

Functionality:

If there is an uninterrupted close contact of 3 seconds between two SAFEDIs, the SAFEDI-IDs are recorded. By synchronizing, via the smartphone app or the SAFEDI Synchro Hub, this information is transferred to an encrypted database. Personal data, location information or time of day are not recorded!

If there is a proven infection, all SAFEDI-IDs are notified that have had anonymous close contact with the person concerned, according to the close contact diary. The notification is made via the confidant in the SAFEDI Portal. Users of the smartphone app also receive a push notification. SAFEDI does not know which users will be notified.

Synchronizing the close contact diary:

IMPORTANT: SAFEDI must be synchronized daily, so that the recorded SAFEDI-IDs can be transferred to the anonymous close contact diary. This allows for accurate analysis and tracing of close contacts.

Synchronization via the SAFEDI smartphone app:

1. Bluetooth on the smartphone must be active.
2. The SAFEDI app must be open. The synchronization is processed automatically. Info: The smartphone is used exclusively for the ID-transfer between the SAFEDI and the SAFEDI Cloud.

Synchronization via the SAFEDI Synchro Hub:

1. The SAFEDI Synchro Hub must be switched on and connected to the power supply.
2. The WiFi on the SAFEDI Synchro Hub must be active. During charging, the SAFEDIs are synchronized. As soon as all SAFEDIs have been synchronized and are fully charged, their LEDs will light up blue continuously.

Function 2 – “Keep your distance”

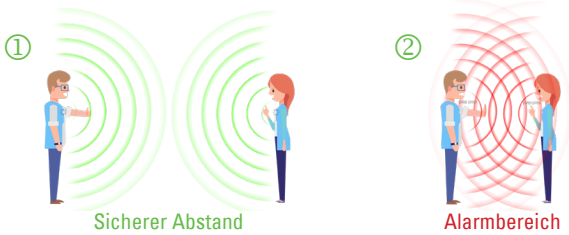

SAFEDI helps its users to keep their distance. SAFEDI is a device that uses Bluetooth to determine the distance to other SAFEDIs. SAFEDI therefore detects other SAFEDI devices in its vicinity (①). If two SAFEDIs come into close contact (②), an optical and optional acoustic warning signal are released until the SAFEDI users move away from each other again. The acoustic signal can be activated or deactivated through the smartphone app. When using a SAFEDI Synchro Hub, the acoustic signal for all SAFEDIs are controlled centrally.

Conduct in the case of an infection:

In case of a positive test or an infection, the confidant must be informed. For this purpose, the infected person must either:

1. Photograph the QR-Code supplied with the SAFEDI packaging and send this to the confidant or
2. Send the 15-digit number supplied with the SAFEDI packaging to the confidant.

The respective country-specific or operational regulations apply.

Data security:

The best data protection is not to save any data. SAFEDI only stores the IDs of the SAFEDIs that have come into contact with its warning area over the course of a day. SAFEDI does not store any personal information.

Possible fault and how to remedy them

(Symptom: Cause → Remedy)

Device does not respond (no display, no signals): Empty battery → Charge battery

Battery is not charging:

Cable not (correctly) connected → Connect or charging device is not plugged in → Check connections on both sides of the cable → Plug in charging device

Cleaning

Wipe the device with a damp cloth and a little mild detergent or disinfectant.

Technical Data

Name	SAFEDI
Dimensions (D × H)	Ø 42, H 20 mm Housing
Material	Polycarbonate
Radio Technology	Bluetooth LE
Transmission Power	< 10 mW
Frequency Range	2,4 GHz
Battery Technology	Lithium-Ion
Rated Voltage Battery	3,7 V
Rated Capacity Battery	120 mAh
Battery Life	14 hours
Charging Port	USB 2.0 Micro-B
Ambient Temperature	2° C - 40° C (non-condensing)
Protection Class	IP 53
EU-Declaration of Conformity	see www.safedi.com

Manufacturer

SAFEDI Distance Control GmbH, Dr. Walter Zumtobel Straße 2, 6850 Dornbirn, Austria, www.safedi.com

Copyright

© 2020. The contents of this document may not be made available to third parties and/or reproduced, even in part, without the written consent of the manufacturer. All technical specifications and images used are protected by copyright. German-language documents are always original documents. Foreign-language documents are translations of the original documents.

